

## Base plate clamp mountings

### Aluminium

#### SPECIFICATION

Aluminium

- matt, slide ground **MT**
- anodized, black **ELS**

Socket cap screws DIN 912  
Stainless Steel AISI 304



#### INFORMATION

The base plate clamp mountings GN 473 have a horizontal and a vertical clamping bore. The vertical clamping bore is additionally fitted with a square.

The bore distance  $m$  of the base plate mountings GN 473 is matched with the clamp mountings GN 477 (see page 1879) and the flanged bolts GN 480 (see page 1885) as well as retaining magnets GN 51.6 (see page 2032).

The standard version of the clamping screw is a socket cap screw with hexagonal socket DIN 912. It can be replaced by an adjustable clamping kits GN 511 (see page 1893) (see table of dimensions).

#### TECHNICAL INFORMATION

- Stainless Steel characteristics (see page A26)
- ISO-Fundamental Tolerances (see page A21)

#### ACCESSORY

- Clamping kits GN 511 (see page 1893)

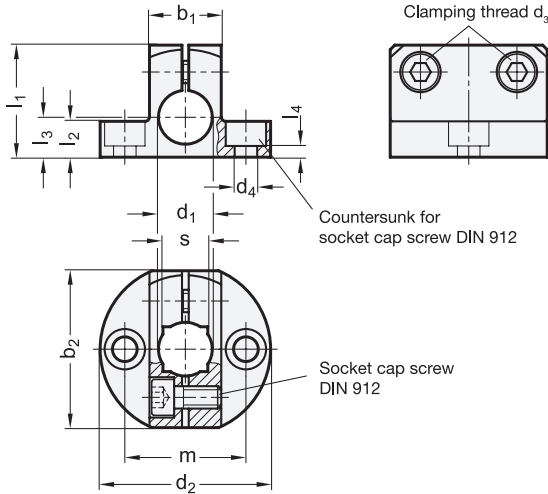

Clamping kit GN 511

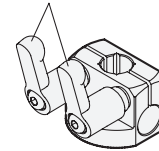

Application example

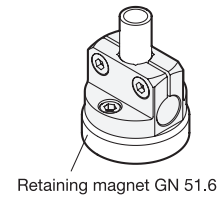

\* Complete with Finish of the Base plate clamp mountings (MT or ELS)

**MT** matt, slide ground  
**ELS** anodized, black

#### GN 473

Description	d1 For shaft tolerance h11	b1	b2	d2	d3	d4	l1	l2	l3	l4	m	s	Clamping kits for d3	Weight
GN 473-B8-*	B 8	14	29	31.5	M 4	M 4	20	7	7	3	22	-	GN 511-M4-14	23
GN 473-B10-*	B 10	16	35	38	M 5	M 5	24	8	8	2.5	27	8	GN 511-M5-16	33
GN 473-B12-*	B 12	16	35	38	M 5	M 5	25	8	8	2.5	27	10	GN 511-M5-16	36
GN 473-B15-*	B 15	20	41	45	M 6	M 6	30	10	10	4	32	12	GN 511-M6-20	57
GN 473-B16-*	B 16	20	41	45	M 6	M 6	31	10	10	4	32	-	GN 511-M6-20	57
GN 473-B20-*	B 20	25	44	50	M 6	M 6	35	12.5	12.5	6.5	36	16	GN 511-M6-25	76

Weight ELS